

# COLUMBUS

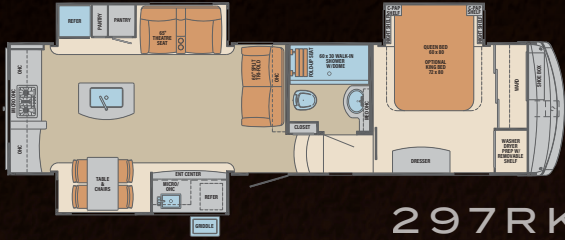

297RK

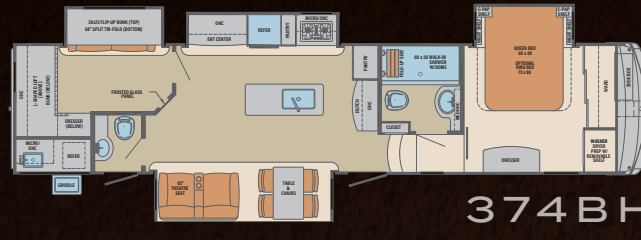

374BH

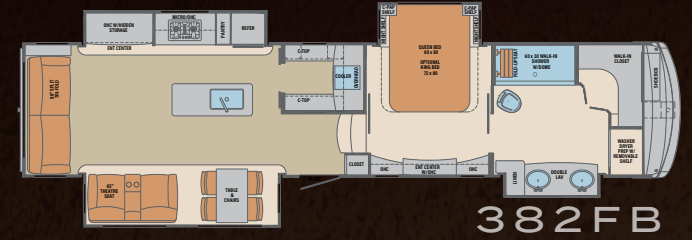

382FB

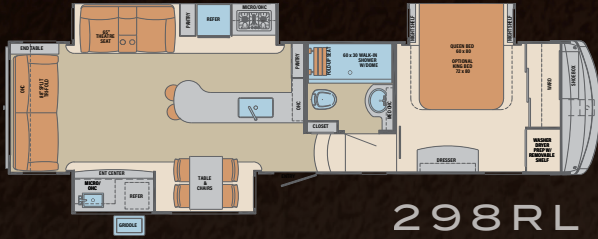

298RL

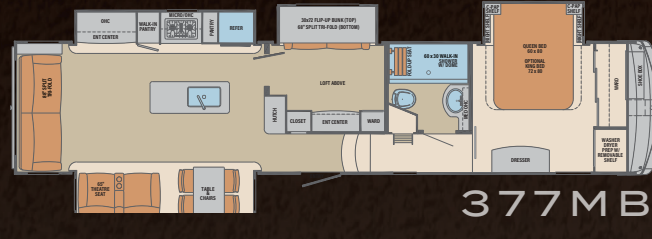

377MB

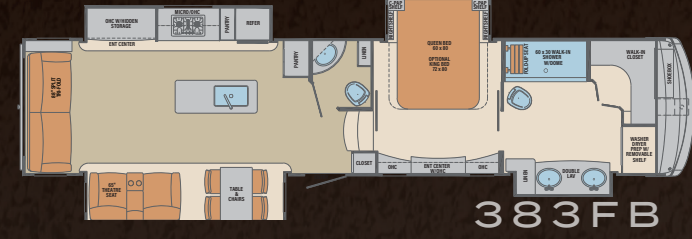

383FB

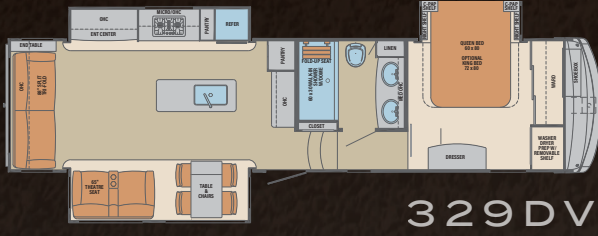

329DV

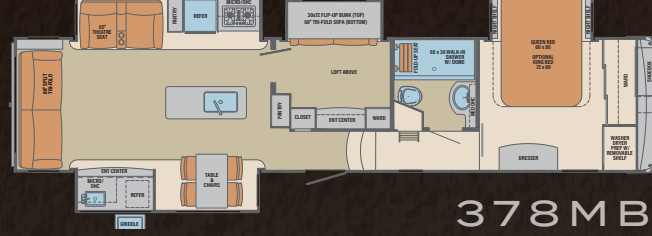

378MB

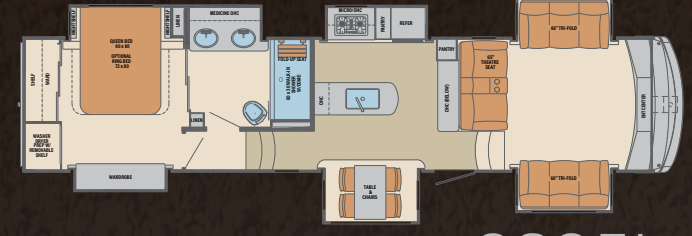

389FL

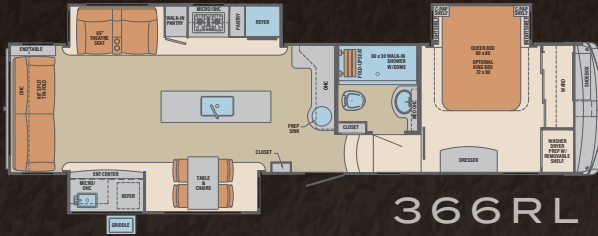

366RL

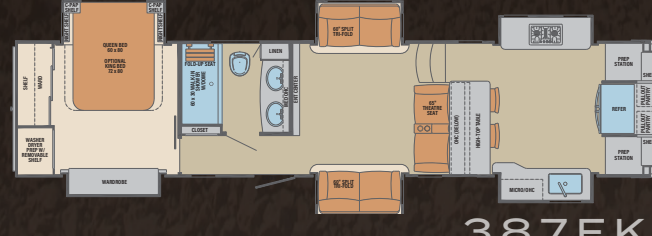

387FK

EXPLORE THE  
ULTIMATE FIFTH WHEEL



▶ Visit [www.palominorv.com](http://www.palominorv.com) for additional photos and information

## 2019 COLUMBUS

	CMF297RK	CMF298RL	CMF329DV	CMF366RL	CMF374BH	CMF377MB	CMF378MB	CMF382FB	CMF383FB	CMF387FK	CMF389FL
HITCH WEIGHT	2169	2309	2035	1913	2276	2378	2251	2560	2632	2255	2751
UVW	11422	11859	11962	12196	13523	13006	13826	13007	12846	13047	13593
GVMR	14422	14859	14962	15196	16276	16006	16251	16050	16164	16200	16593
CCC	3000	3000	3000	3000	2753	3000	2425	3043	3318	3153	3000
OVERALL LENGTH	35' 5"	35' 5"	37' 6"	38' 7"	41' 2"	41' 2"	41' 2"	41' 2"	41' 2"	41' 2"	41' 2"
EXT. HEIGHT (w/o 2nd AC)	12'4"	12'4"	12' 4"	12'4"	12'4"	12'4"	12'4"	12' 4"	12'4"	12'4"	12'4"
EXT. WIDTH	101"	101"	101"	101"	101"	101"	101"	101"	101"	101"	101"
FRESH WATER (gal.)	75gal	75gal	75gal	75gal	75gal	75gal	75gal	75gal	75gal	75gal	75gal
GREY WATER (gal.)	78gal	71gal	71gal	71gal	71gal	71gal	71gal	78gal	78gal	78gal	75gal
BLACK WATER (gal.)	39gal	39gal	39gal	39gal	78gal	39gal	39gal	39gal	78gal	39gal	39gal
AWNING SIZE	16'	16'	17'	18' & 11'	16'	20'	10'6" & 20'	11' & 12'	11' & 12'	19'	20'

### CONSTRUCTION

- 101" wide body
- All welded aluminum frame superstructure
- Drop Frame pass-thru storage compartments
- 5/8 tongue-groove plywood floor
- R40 Residential 5" radius Wood Truss Roof
- 6'6" height slides (living area slides)
- (5) heat ducts out of traffic areas
- Snap-in ceiling molding-no staples or tape
- 12V heat pads on all holding tanks
- R38 floor insulation
- R40 roof insulation
- R11 sidewall insulation
- Mor/Ryde CRE3000 Suspension system
- Vacuum Bonded Walls
- Lippert Axles w/Self adj brakes
- 16" wheels w/nitro fill tires
- Rear View Camera prep
- Slide Topper Prep

### INTERIOR

- Large frameless tinted windows throughout
- Hidden hinges
- Dovetail constructed reinforced doors & drawers with upgraded hardware
- Upgraded crack/mold/mildew-resistant flooring
- Upgrade true solid surface countertops bath/kitchen
- LED lights
- Residential crown molding throughout unit
- Solid Wood Slide Fascia
- 24 ounce carpet
- Roller night shades
- Solid Wood steps
- Central vacuum system
- Large entry closet for jacket & shoe storage

### EXTERIOR

- Slam latches on all storage doors
- Magnetic Compartment Door Holds
- 2-tone aluminum wheels
- 2-tone wheel well skirting
- Painted fiberglass front cap
- 2 exterior color choices w/ Grey metal skirting (white, full body paint)
- Heated utility convenience center
- Black tank flush
- Outside FM/Bluetooth receiver w/ USB port
- Electric rear stabilizer jacks
- Outside shower
- 2-30 lb LP tanks w/ auto switch
- Full view entry door w/window and screen door
- Quick battery disconnect
- Power awning w/LED lighting
- 7000 lb axles (all models)
- Crank down spare tire
- Storage rack in front compartment
- Tire pressure monitoring system
- 2" hitch receiver

### FURNITURE

- Power w/USB charging residential theater seating w/storage
- Bi-fold 80" Sleeper sofa (per model)
- Solid Wood entertainment & end table tops
- Residential high end dining chairs w/ storage

### BEDROOM

- Laundry hamper (most models)
- 13.5 Coleman Serenity bedroom A/C
- 32" TV Backer and hookups
- Solid Wood dresser top
- Pillow top mattress

- French mirrored sliding closet doors
- High end bedspread & pillows
- Reading Lights with USB Charger
- CPAP Shelves

### APPLIANCES

- Upgrade 8 cu ft refrigerator w/adjustable temp settings and raised panel doors
- Furrion 3 burner gas cooktop
- Furrion 22" Residential oven
- 50" LED TV w/Sound Bar and DVD player
- 10 gallon water heater w/quick recovery
- Washer / dryer prep
- Full system water purifier
- 30" residential microwave
- 15,000 BTU Coleman Serenity A/C
- 35,000 BTU furnace
- Omnidirectional rooftop antenna with 4G LTE/Wifi Prep
- 50 AMP Converter w/ built-in charge wizard
- 1000W Inverter

### KITCHEN

- Pull out pantry
- Storage for sink covers (some models)
- Recessed solid surface sink covers
- Residential under counter storage
- Residential backsplash
- Additional lighting above sink area
- Large single bowl stainless steel sink
- Single lever faucet w/pull out sprayer
- Trash can w/ dedicated storage (some models)

### BATHROOM

- 60"x30" one piece fiberglass shower w/ wood flip up seat & built in shelves for toiletries
- Solid surface counter top

- 3 speed power vent
- Porcelain toilet
- Towel rack built into door
- Shower Skylight

### OPTIONS

- Mor/Ryde pin box
- Electric fireplace
- 6 Point Hydraulic Level Up (required on 1492PKG)
- Stackable washer / dryer
- Dual pane windows
- Euro entry door handle
- MCD UV reflective day shades (Living Room only)
- Kitchen Maxx Fan w/Rain sensor
- 20cu ft residential refrigerator w/Inverter
- 18 cu ft gas electric refrigerator
- King bed
- Upgrade Memory Foam mattress
- Fiberglass rear cap
- Generator prep
- 5/5 generator install (includes gen prep)
- Wood-look floor
- Tile-look floor
- Metal wrapped awning
- 175" Goodyear H rated tires w/upgraded rims
- 200 Watt Solar Panel (installed) w/2 Batteries
- Zero carpet interior

- **Voyager package (Columbus only, forced option) includes:** Frameless Windows, Full System Water Purifier, 50" LED TV, Sound Bar, Battery Disconnect, Ext AM/FM/IPOD/CD w/2 Speakers, Hardwood Slide Out Fascia, 2 Tone Alum Wheels, 1 Piece Fiberglass Shower, G-rated Tires, 12 Volt Heat Pads on Tanks, LED Awning Lights,

Mor/ryde Strut Assist Entry Steps, Mor/ryde CRE/3000 Suspension, Syphon 360 Vent Covers, MCD Night Roller Shades, Friction Hinge Full Length Window Main Entry Door, Go Power Solar Prep, MyRV System, Ottoman, Wifi Booster w/ 4G, Ladder

- **1492 Package (366RL, 378MB, 382FB, 383FB, 387FK, 389FL only):** 32" LED bedroom TV, Upgrade Stone Backsplash, Bose Premium Soundbar, Shiplap Island, Induction Cooktop, Wine Fridge, Tankless Water Heater, Heated Towel Bar, Mor/Ryde LRE 4000 suspension, Mor/Ryde Equalizers, Dishwasher, Waste Management, 1492 Slide Fascia, Power Cord Reel, Live Edge Dinette Table, Residential Dinette Chairs(2), Outside TV/Bracket, Two Tone Painted Front Cap, Fiberglass Rear Cap (W/A389FL), 1492 Graphics Pkg, 1492 Pillow, Wifi 4G

### TOWABLES DEFINITIONS

**GVWR (Gross Vehicle Weight Rating)** - is the maximum permissible weight of the unit when fully loaded. It includes all weights, inclusive of all fluids, cargo, optional equipment and accessories. For safety and product performance do NOT exceed the GVWR.

**GAWR (Gross Axle Weight Rating)** - is the maximum permissible weight, including cargo, fluids, optional equipment and accessories that can be safely supported by a combination of all axles.

**UVW (Unloaded Vehicle Weight)\*\*** - is the typical weight of the unit as manufactured at the factory. It includes all weight at the unit's axle(s) and tongue or pin and LP Gas. The UVW does not include cargo, fresh potable water, additional optional equipment or dealer installed accessories. \*Estimated Average based on standard build optional equipment.

**CCC (Cargo Carrying Capacity)\*\*** - is the amount of weight available for fresh potable water, cargo, additional optional equipment and accessories. CCC is equal to GVWR minus UVW. Available CCC should accommodate fresh potable water (8.3 lbs per gallon). Before filling the fresh water tank, empty the black and gray tanks to provide for more cargo capacity. \*\*Estimated average based on standard build optional equipment

Each Forest River RV is weighed at the manufacturing facility prior to shipping. A label identifying the unloaded vehicle weight of the actual unit and the cargo carrying capacity is applied to every Forest River RV prior to leaving our facilities. The load capacity of your unit is designated by weight, not by volume, so you cannot necessarily use all available space when loading your unit.



**PALOMINO**  
COLUMBUS BY PALOMINO  
A Division Of Forest River, Inc.  
105-1/2 C.R. 14 • Middlebury, In 46540  
www.palominoRV.com



#### Learn More

Scan this barcode using a QR Reader on your smart phone to learn more about Forest River.



All information contained in this brochure is believed to be accurate at the time of publication. However, during the model year, it may be necessary to make revisions and Forest River, Inc., reserves the right to make all such changes without notice, including prices, colors, materials, equipment and specifications as well as the addition of new models and the discontinuance of models shown in this brochure. Therefore, please consult with your Forest River, Inc., dealer and confirm the existence of any materials, design or specifications that are material to your purchase decision.

©2019 Palomino RV. A division of Forest River, Inc., a Berkshire Hathaway Company. 9/19 Columbus