

# RIVER RANCH

BY COLUMBUS

LUXURY FIFTH WHEELS



VISIT [WWW.PALOMINORV.COM](http://WWW.PALOMINORV.COM) FOR ADDITIONAL PHOTOS AND INFORMATION

## CONSTRUCTION

- 84" Interior Height throughout
- 101" wide body
- All welded aluminum frame superstructure
- 3/4" tongue and groove plywood floor
- R-40 Residential 5" radius wood truss roof
- 6" height slides (living area slides)
- (5) heat ducts out of traffic areas
- Snap-in ceiling molding - no staples or tape
- 12V heat pads on all holding tanks
- R-38 floor insulation
- R-40 roof insulation
- R-11 sidewall insulation
- Vacuum Bonded Walls w/ Azdel backing
- Worry Free Composite Floors in Basement and slide boxes
- 16" wheels with nitro fill tires

## EXTERIOR

- Slam latches on all storage doors
- Magnetic compartment door holds
- 2-tone aluminum wheels
- 2-tone wheel well skirting
- Painted fiberglass front cap
- 2 exterior color choices with gray metal skirting (white, full body paint)
- Heated utility convenience center
- Black tank flush
- JBL Outside Speakers
- Outside shower
- (2) 30-lb. LP tanks with auto switch (EZ replacement)
- Full view entry door with window and screen door
- Quick battery disconnect
- Power awnings with LED lighting (21'x15')
- 8,000 lb. axles
- Crank down spare tire
- Storage rack in front compartment
- TST Tire Pressure Monitoring System

## KITCHEN

- Residential under counter storage
- Additional lighting above sink and dinette areas
- Deep Residential Single bowl stainless steel sink w/accessories kit
- Single lever faucet w/pull out sprayer
- Trash can with dedicated storage
- Full pantry

## APPLIANCES

- Residential Stainless Steel Gas Range
- 30" residential microwave
- 50" LED TV with sound bar with JBL Sound System
- Tankless Water Heater
- Washer/dryer prep
- Basement Residential 2 Ton Coleman Serenity A/C w/Heat Pump
- 35,000 BTU Furnace with Residential Floor Ducting Shared w/A/C & Home Filter

## BEDROOM

- Cabinet mounted auto retract Entertainment TV
- Solid surface dresser top
- Pillow top King size mattress
- French mirrored sliding closet doors
- High end bedspread/pillows
- USB reading lights
- Laundry hamper
- Ceiling fan
- 5000 BTU Fireplace

## BATHROOM

- 60" x 30" one-piece Signature Spa walk-in shower with Teak wood seat
- Solid-surface counter top
- 3-speed power vent

- Porcelain toilet
- Towel rack built into door
- Vessel Sink w/ Waterfall faucet

## RIVER PACKAGE (MANDATORY)

- 6 Point Hydraulic Leveling System
- Mor/Ryde SRE/4000 Suspension
- 8,000 lb Axles
- 2-tone Aluminum Wheels
- G-rated Tires w/G-rated Spare
- Upgraded Pinbox
- Tankless Water Heater
- Residential 2-ton HVAC System
- Power Cord Reel
- 2" Hitch Receiver
- Tire Pressure Monitoring System
- Frameless Windows
- Battery Disconnect
- 12V Heat Pads on Tanks
- LED Awning Lights
- Mor/Ryde Strut Assist Step Above Entry Steps
- Syphon 360 Vent Covers
- 36" Friction Hinge Entry Door w/Euro Handle
- MyRV System
- Wifi Booster w/4G LTE Capability
- Ladder
- LP Quick Connect
- Back Up Camera Prep
- Slide Topper Prep
- Go Power Solar Prep
- Metal Wrapped Awning

## RANCH PACKAGE (MANDATORY)

- JBL Sound System
- Wall Mounted Free Standing Dinette Table w/Extension
- Residential Dinette Chairs(2)
- 2-tone Painted Front Cap
- 50" LED TV

- 60" x 30" Signature Spa Walk-in Shower w/Teak Wood Seat
- Entertainment Bedroom TV
- MCD Day/Night Roller Shades
- Memory Foam Mattress
- Hybrid Carpet
- Aluminum Bed Base
- Power Theater Seating w/USB
- 50/50 Split Sleeper Sofa
- Upgraded Gold Hardware
- Deep Bowl Stainless Steel Kitchen Sink
- Ceiling Fan in Living Room and Bedroom
- Samsung Stainless Steel Residential Appliance Package
- Washer/Dryer Prep
- Porcelain Toilet w/Foot Flush
- Large Kitchen Pantry (select models)
- Electric Fireplace
- Kitchen Maxx Air Vent w/Rain Hood
- King Bed
- 2 Folding Chairs
- Wood Look Linoleum

## OPTIONS

- 18 cu. ft. Gas/Electric Refrigerator
- 23 Cu Ft Residential Refer w/Inverter & Ice
- Dual Pane Windows
- Stackable Washer/Dryer Installed
- Generator Prep (N/A w/Generator Install Option)
- 5.5 kW Generator Installed (Includes Generator Prep)
- Goodyear H-Rated Tires w/Upgraded Rims
- Full Body Paint Midnight Black (Required w/Paint Exterior)

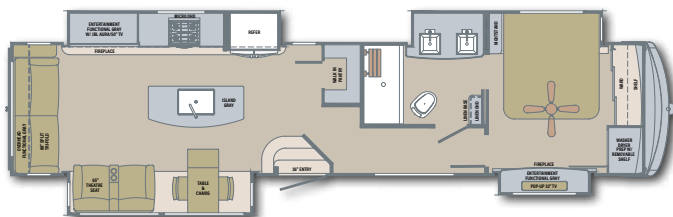

**390RL**

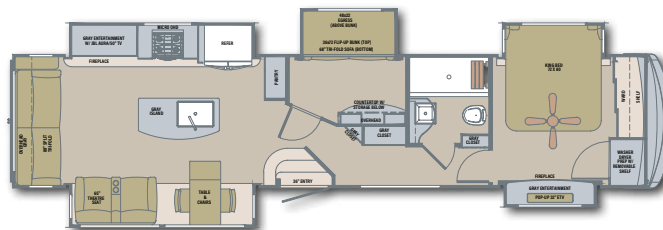

**392MB**

SPECIFICATIONS	390RL	392MB
<b>HITCH WEIGHT</b>	2,295	2,455
<b>UVW</b>	13,944	14,844
<b>GVWR</b>	17,999	17,999
<b>CCC</b>	4,055	3,155
<b>OVERALL LENGTH</b>	42' 0"	42' 0"
<b>EXT. HEIGHT (w/o 2nd AC)</b>	13' 6"	13' 6"
<b>EXT. WIDTH</b>	101"	101"
<b>FRESH WATER (gal.)</b>	75 gal	75 gal
<b>GREY WATER (gal.)</b>	78 gal	78 gal
<b>BLACK WATER (gal.)</b>	39 gal	39 gal
<b>AWNING SIZE</b>	21' & 15'	21' & 15'









**24/7 EMERGENCY  
ROADSIDE ASSISTANCE  
WITH VEHICLE PURCHASE**

TOWING JUMP-STARTS TIRE CHANGES FLUID DELIVERY LOCKOUT SERVICE	WINCH-OUT MOBILE MECHANIC TECHNICAL SUPPORT DEALER LOCATOR SERVICES
---	--

**SAFERIDER RV  
MOTOR CLUB**

\*VALID FOR 1 YEAR FROM DATE OF PURCHASE



### PRE-DELIVERY INSPECTION

20,000 square feet of quality assurance. The bare essentials for a premium product. This state-of-the-art facility gives immediate daily feedback to production for quality assurance in every unit built.



Learn More  
Scan this barcode using  
a QR Reader on your  
smart phone to learn  
more about Forest River.



A Berkshire Hathaway company.

All information contained in this brochure is believed to be accurate at the time of publication. However, during the model year, it may be necessary to make revisions and Forest River, Inc., reserves the right to make all such changes without notice, including prices, colors, materials, equipment and specifications as well as the addition of new models and the discontinuance of models shown in this brochure. Therefore, please consult with your Forest River, Inc., dealer and confirm the existence of any materials, design or specifications that are material to your purchase decision. ©2019 Palomino RV, a Division of Forest River, Inc., a Berkshire Hathaway Company. 10/19 Columbus

**FREE MEMBERSHIP**  
to Forest River Owners' Group

[www.forestriverfrog.com](http://www.forestriverfrog.com)



**PALOMINO**

COLUMBUS BY PALOMINO  
A Division Of Forest River, Inc.  
105-1/2 C.R. 14 • Middlebury, In 46540  
[www.palominorv.com](http://www.palominorv.com)



[www.ForestRiverBuyLocal.com](http://www.ForestRiverBuyLocal.com)

### PALOMINO OWNER "DIGITAL KIT" APP

Now you can have your Owner's Manual with you wherever you are. Download our FREE App from the App Store or Google Play and you'll have the information right at your fingertips.



YOUR PALOMINO DEALER: